

Certified, Filed and or Recorded on  
April 15, 2015 10:57 AM

BENTON COUNTY MINNESOTA  
MARILYN J NOVAK  
COUNTY RECORDER

By: CK

G -- V -- I

# CERTIFICATE OF LOCATION OF GOVERNMENT CORNER

NORTH QUARTER Corner of Section 31, Township 38, Range 29  
4TH Principal Meridian, State of Minnesota, County of Benton

At the corner location shown on the sketch:

On 1-28-15 found a 1/2" REBAR CAPPED LS 42621

left monument as found       lowered monument       removed monument (explain)

On \_\_\_\_\_ placed an \_\_\_\_\_

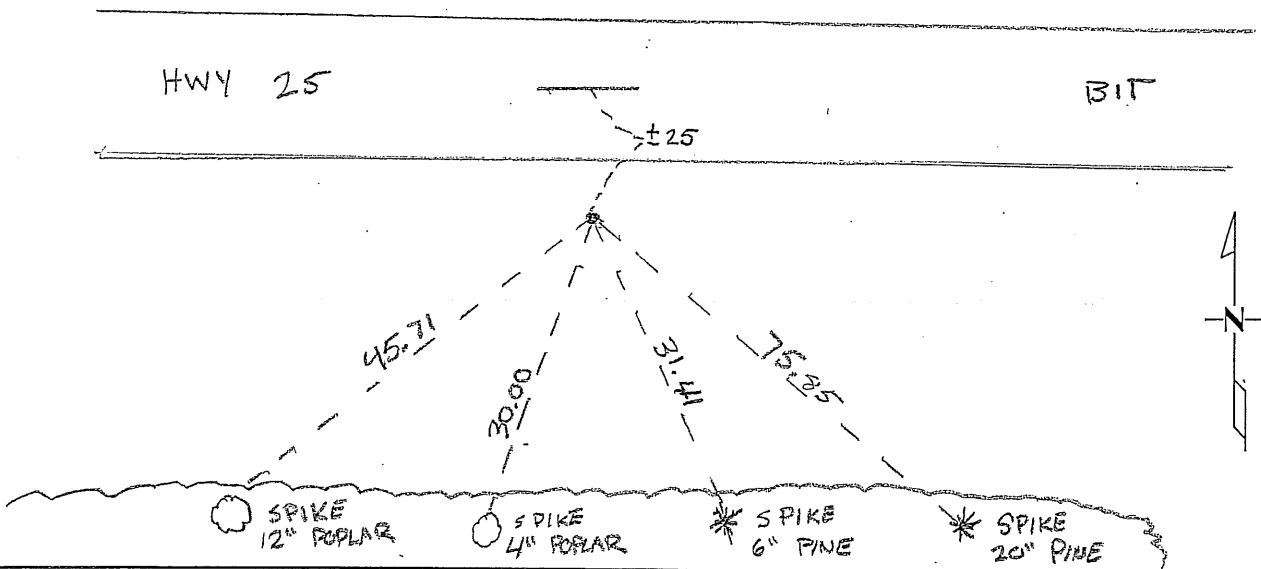
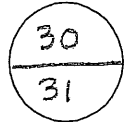

Statement of evidence for this corner location is on back of this page.

I hereby certify that this survey, plan, or report was prepared by me or under my direct supervision and that I am a duly Licensed Land Surveyor under the laws of the state of Minnesota.

Signature Jerome C Wittstock  
Jerome C. Wittstock, PS, CFedS, Benton County Surveyor  
License No. 19552

Date: 4/15/2015

Benton County Surveyor's Office  
 Jerome C. Wittstock, County Surveyor  
 Minnesota License No. 19552

**Statement of Evidence:****B311**

North Quarter Corner of Section 31, Township 38 North, Range 29 West, Alberta Township, 4<sup>th</sup> Principal Meridian, Benton County, Minnesota.

1855 Original US General Land Office survey set a wood post at this location and bearing trees were recorded.

14" Blk Ash	S 14 E	28 links
9" Blk Ash	N 40 E	55 links

1940's Roll F-1, of the MN/DOT road alignment records for TH 218 (25), File No. 12-80, note the corner assumed at the intersection of a fence line south and a road east/west. This location is 26.9 feet south of the present centerline at station 511+59.5 (2628.2 feet to NW corner and 2655.0 feet to the NE corner).

2002 No records were found on this corner in the Benton County records.

2008 The Benton County Surveyor's Office found a 1/2" rebar capped 42621 and a 1/2" iron pipe capped 12236. The found iron pipe measures South 37 degrees 40 minutes 58 seconds East 1.62 feet from the found rebar capped 42621.

Coordinates Obtained by GPS (1/2" rebar capped 42621)

NAD 83 (1996 Adjustment)

N- 169631.778

E- 513595.167

2014 The Benton County Surveyor's Office found the 1/2" rebar capped 42621 and 1/2" iron pipe capped 12236. The alignment information for State Trunk Highway 25 was obtained from MnDOT and converted from NAD83 '86 to NAD83 '96. The station and offset shown on the MnDOT road alignment records from 1940 fits closer to the found rebar than the found iron pipe. The found rebar falls on a fence to the south and falls 25 feet south of the centerline of STH 25. Since the rebar capped 42621 fits the MnDOT information better, it is accepted as marking the corner position.

2015 The Benton County Surveyor's Office found the 1/2" rebar capped 42621 and verified the 2008 coordinates