

A 361580

Certified, Filed and or Recorded on  
Nov. 06, 2008 AT 08:41AM

Signed: CK  
MARILYN J NOVAK G V  
BENTON COUNTY MINNESOTA  
MARILYN J NOVAK  
COUNTY RECORDER

# CERTIFICATE OF LOCATION OF GOVERNMENT CORNER

EAST QUARTER Corner of Section 35, Township 37N, Range 29W  
4TH Principal Meridian, State of Minnesota, County of Benton

At the corner location shown on the sketch:

- On 23 OCT 2008 found a 1/2" OPEN IRON PIPE
- left monument as found       lowered monument       removed monument (explain)
- On \_\_\_\_\_ placed on \_\_\_\_\_

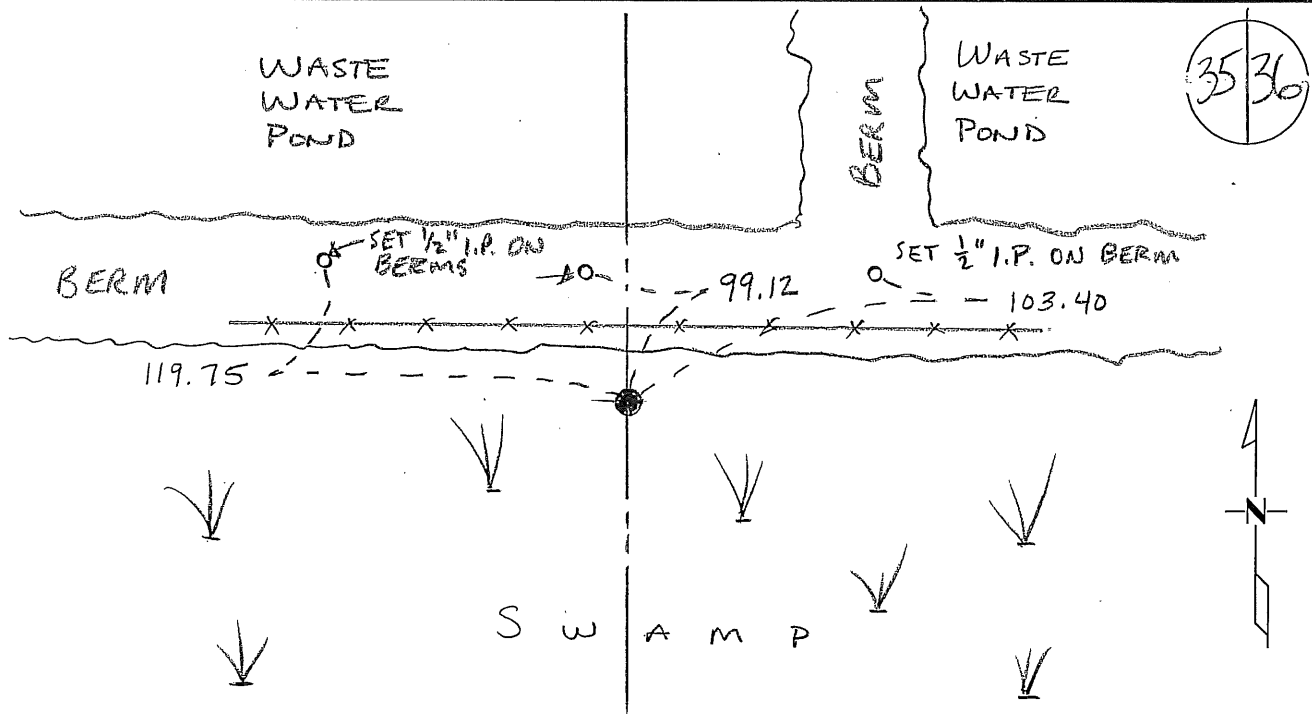

\* 1/2 IN IRONS SET FOR TIES - TOP CENTER BERM N 12' +/- OF FENCE

Statement of evidence for this corner location is on back of this page.

I hereby certify that this document was researched and prepared by me or under my direct supervision and that I am a licensed Land Surveyor under the laws of the State of Minnesota.

Signature Jan W. Oly  
Deputy Benton County Surveyor  
License No. 45872

Date: 11/04/2008

Benton County Surveyor's Office  
 Jason W. Oberg, Deputy County Surveyor  
 Minnesota License No. 45872

**Statement of Evidence:****H353**

East Quarter Corner of Section 35, Township 37 North, Range 29 West, Gilmanton Township, 4<sup>th</sup> Principal Meridian, Benton County, Minnesota.

This corner is noted on the following recorded plats

<i>PHEASANT GROVE TWO</i>	8/20/1992	Sidney Williamson
<i>STERLING RIDGE</i>	4/23/1998	Sidney Williamson
<i>STERLING RIDGE TWO</i>	7/28/1999	Sidney Williamson

1855 Original US General Land Office survey set a wood post with bearing trees noted as:

14" Blk Ash	S 46 W	15 links
6" Blk Ash	S 12 E	25 links

2002 Westwood Professional Services, Inc. found no record information on this corner in the Benton County records.

2005 Daniel Kron, LS 42621, reported finding a ½" iron pipe that fit the plats done by Williamson. He measured 2600.23 feet to the SE corner.

2008 The County Surveyor's Office searched and found a ½" iron pipe approximately 120± feet south and 40± feet west of the southeast corner of the westerly waste water pond, in a swamp. The position gives a distance of 2600.28 feet to the SE corner, which agrees well with the 2600.23 feet distance reported by Kron in 2005. Position also gives a distance to the Center of Sec. 35, as monumented, of 2642.24 ft. which agrees well with the above mentioned plats. The Surveyor accepts the position and set ties above the swamp on top of the waste water pond berm.

Coordinates Obtained by GPS to ½" iron pipe  
 NAD 83 (1996 Adjustment)  
 N-134994.853  
 E-537089.584