

CERTIFICATE OF LOCATION OF GOVERNMENT CORNER

Northeast Corner of Section 15, Township 38, Range 30, 4 P.M.

STATE OF MINNESOTA, County of Benton

At the corner location shown on the sketch:

On Nov. 11, 1984 found a 4 inch iron pipe at the centerline of roads to the
DATE north, south, east and west. (Down 3.0 feet)

left monument as found, lowered monument, removed monument (explain)

On April 22, 1984 placed a Benton County Cast Iron Monument; over the 4 inch
DATE iron pipe.

*twice
11
12
10
19
15
marked
14
36.10*

SKETCH OF REFERENCE TIES

RH: Redhead Spike

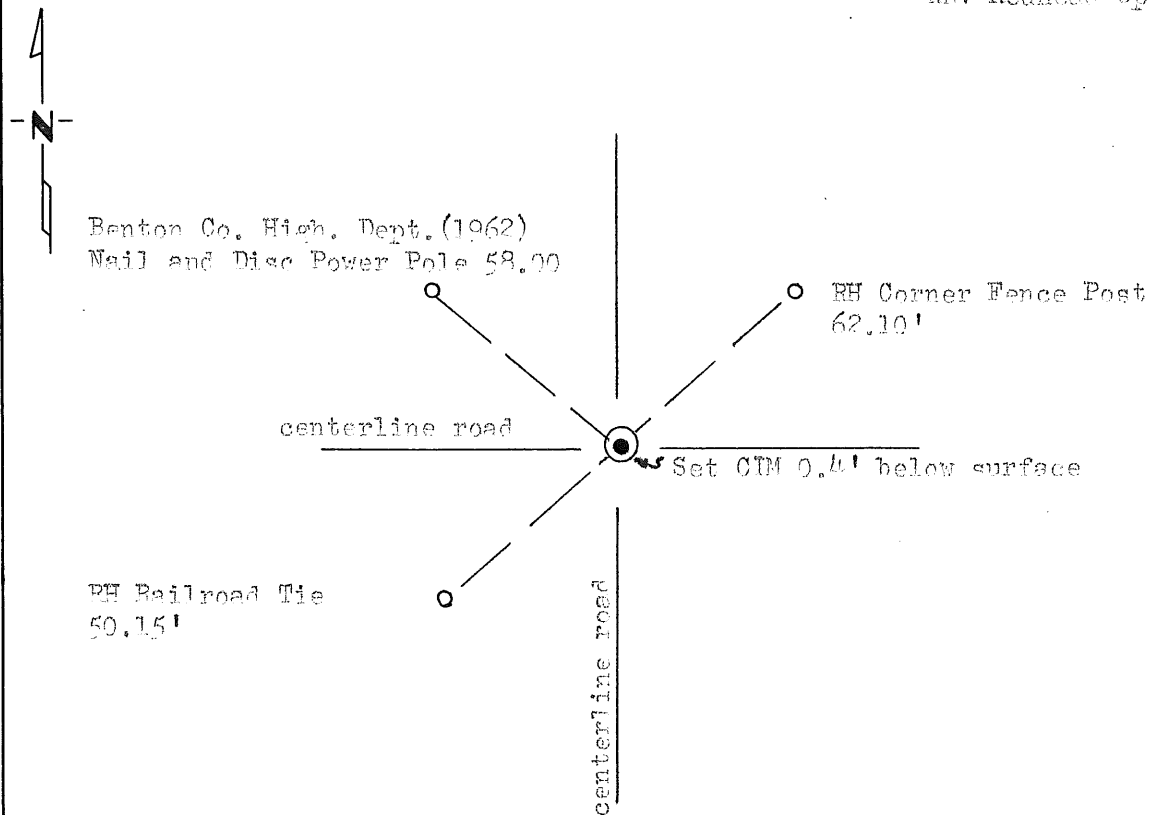

173452

Statement of evidence relative to this corner location is on back of page.

I hereby certify that this document and the data contained herein was prepared by me or under my direct supervision.

Ronald Engelmay 4-23-85
SIGNATURE DATE

Registration No. 13334

Land Surveyor, Professional Engineer

County Surveyor, County Engineer

OFFICE OF THE REGISTER OF DEEDS

County of Benton

I hereby certify that this document was filed in the Reg. of Deeds office at 3 P. .M. on the 16th day of May A.D., 1985

Register of Deeds Alida C. Engelmay
By _____, Deputy

DOCUMENT NO. _____

Statement of Evidence:

Northeast Corner Section 15-38-20.

The GLO shows a post set at this corner.

Benton County Highway Dept. shows iron pipe at this corner in 1962.

Nov. 11, 1984 I found a 4 inch iron pipe at the centerline of roads to the north, south, east and west.

April 22, 1985 Set Benton County Cast Iron Monument.