

MARILYN J. NOVAK
COUNTY RECORDER
BY Marilyn J. Novak DEPUTY

OFFICE OF
BENTON COUNTY RECORDER
BENTON COUNTY, MN
CERTIFIED TO BE FILED
AND/OR RECORDED

291177

2002 OCT 30 P 3: 21

CERTIFICATE OF LOCATION OF GOVERNMENT CORNER

NORTHEAST Corner of Section 10, Township 37, Range 30
4TH Principal Meridian, State of Minnesota, County of BENTON

At the corner location shown on the sketch:

On 10/17/02 found a 6" X 8" X 12" POINTED STONE
DATE

left monument as found lowered monument removed monument (explain)

On 10/17/02 placed a CAST IRON MONUMENT
DATE

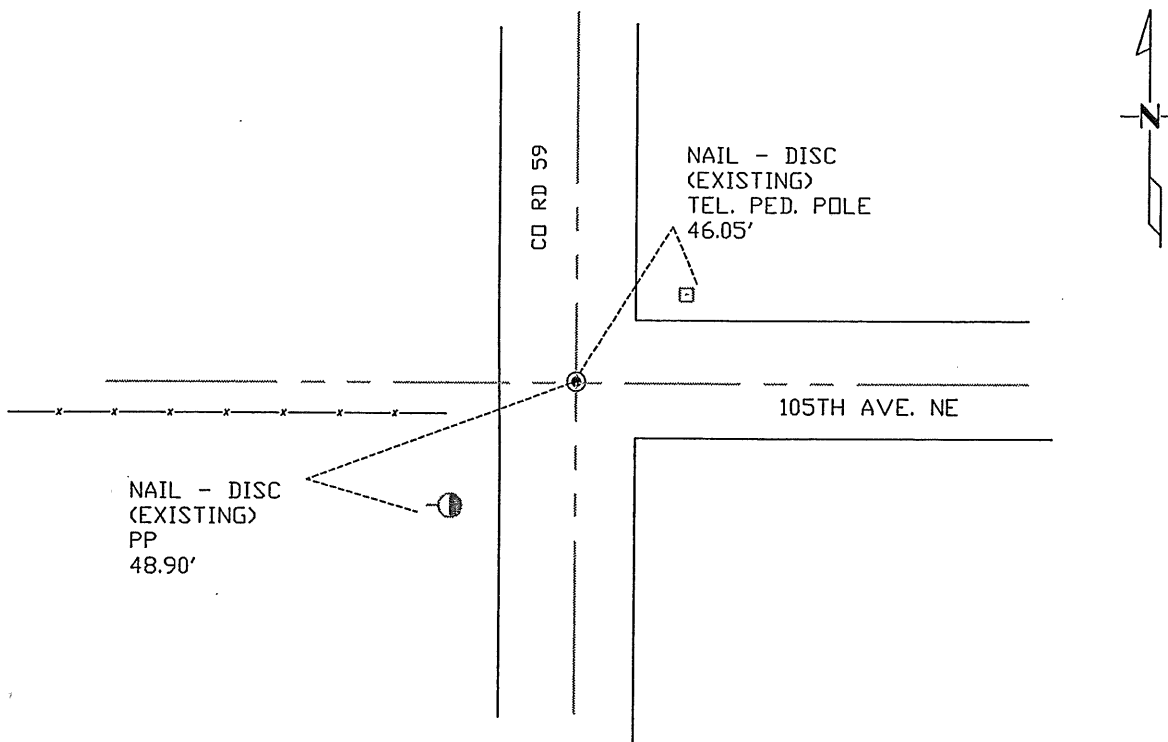

Statement of evidence for this corner location is on back of this page.

I hereby certify that this document was researched and prepared by me or under my direct supervision and that I am a licensed Land Surveyor under the laws of the State of Minnesota.

Signature [Signature] Date 10/17/02 License No. 12684

Title: Land Surveyor Professional Engineer County Surveyor County Engineer

Statement of Evidence:

F102

The Northeast Corner of Section 10, Township 37 North, Range 30 West, 4th Principal Meridian, (Mayhew Lake Township) Benton County, Minnesota.

1852 Corner established by GLO and marked by a wood post with bearing trees noted as.

10" Aspen	S 16 ½ E	4 links
12" Aspen	N 53 E	4 links

Un-dated County records give ties to corner by Elletson as follows:

14" Oak NW 80.9
3rd FP W 38.8

1976 County records dated 6/21/76 show rock 26" below road top and 9" below black dirt. Set iron above rock, 4" below road surface.

Ties: T.P. & Ped. NE 46.0
PP SW 48.95
Cor FP W 169.45

2002 On 10/08/02 Westwood Professional Services, Inc. found a ½ " iron pipe with cap marked BWK 10918 in the center of north, south, and east roads and 3 feet north of fence line west. No evidence of Elletson's ties remain. Took ties to two of the 1976 ties as follows:

Spk & Disc in T.P. & Ped. NE 47.36'
Spk & Disc in PP SW 47.33'

On 10/17/02 Westwood Professional Services, Inc. dug with backhoe in road intersection. Down 3.5 feet found a 6" x 8" x 12" pointed stone with wood hubs and 1 ½ " solid iron pin on top. Assume that the stone was set or found by Elletson and therefore we accept the stone as marking the perpetuated position of the corner. Set cast iron monument on top. Corner is 2.0 feet east of found iron pipe. Stone fit 1976 ties.